

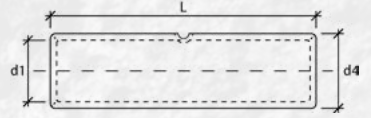

# SEM-D

**DIN 46267-1 TİP SIKMALI EK MUFLARI**  
DIN 46267-1 TYPE BUTT CONNECTORS



5846 sayılı yasa gereği fotoğrafların izinsiz yayınlanması ve kullanılması kesinlikle yasaktır.

ÜRÜN KODU ORDER CODE	KABLO KESİTİ CABLE SECTION (mm)	BOYUTLAR DIMENSIONS			KUTU ADEDİ BOX PCS.	KUTU AĞIRLIĞI BOX WEIGHT	KOLİ ADEDİ PARCEL PCS.	KOLİ AĞIRLIĞI BOX WEIGHT	BİRİM FİYATI UNIT PRICE TL
		d1	d4	L					
SEM-D/006	<b>6</b>	3,8	5,5	30,0	700	~2,4 kg.	4200	~14,4 kg.	9,25
SEM-D/010	<b>10</b>	4,5	6,0	30,0	600	~1,9 kg.	3600	~11,4 kg.	9,25
SEM-D/016	<b>16</b>	5,5	8,5	50,0	200	~2,9 kg.	1200	~17,4 kg.	26,25
SEM-D/025	<b>25</b>	7,0	10,0	50,0	150	~2,7 kg.	900	~16,2 kg.	32,50
SEM-D/035	<b>35</b>	8,2	12,5	50,0	100	~3,9 kg.	600	~23,4 kg.	57,50
SEM-D/050	<b>50</b>	10,0	14,5	56,0	80	~3,4 kg.	480	~20,4 kg.	83,50
SEM-D/070	<b>70</b>	11,5	16,5	56,0	50	~2,7 kg.	300	~16,2 kg.	97,50
SEM-D/095	<b>95</b>	13,5	19,0	70,0	35	~3,1 kg.	210	~18,6 kg.	148,50
SEM-D/120	<b>120</b>	15,5	21,0	70,0	25	~2,4 kg.	150	~14,4 kg.	164,50
SEM-D/150	<b>150</b>	17,0	23,5	80,0	20	~2,9 kg.	120	~17,4 kg.	246,00
SEM-D/185	<b>185</b>	19,0	25,5	85,0	12	~2,1 kg.	72	~12,6 kg.	276,00
SEM-D/240	<b>240</b>	21,5	29,0	90,0	10	~2,4 kg.	60	~14,4 kg.	396,00
SEM-D/300	<b>300</b>	24,5	32,0	100,0	8	~2,4 kg.	48	~14,4 kg.	531,00
SEM-D/400	<b>400</b>	27,5	38,5	150,0	4	~3,0 kg.	24	~18,0 kg.	1.268,00
SEM-D/500	<b>500</b>	31,0	42,0	160,0	3	~2,7 kg.	18	~16,1 kg.	1.505,00
SEM-D/625	<b>625</b>	34,5	44,0	160,0	3	~2,4 kg.	18	~14,2 kg.	1.664,00
SEM-D/800	<b>800</b>	40,0	52,0	200,0	1	~1,5 kg.	6		
SEM-D/1000	<b>1000</b>	44,0	58,0	200,0	1	~2,0 kg.	6		

## SEM-D ÖZELLİKLERİ

HAMMADDE	EN 13600 BAKIR BORU
METERIAL	ELECTROLYTIC COPPER CONFORMED TO EN 13600
KAPLAMA	KALAY
COATING	TIN PLATED
BAĞLANTI	SIKMA / LEHİM
JOINT	CLAMP COUPLING
DIN NORMU 46267-1 'E UYGUNDUR	
CONFORMED TO DIN 46267-1	

